

# CONCAVE AND CONVEX CURVES

## GRAVITY LAYOUT

NOT TO SCALE

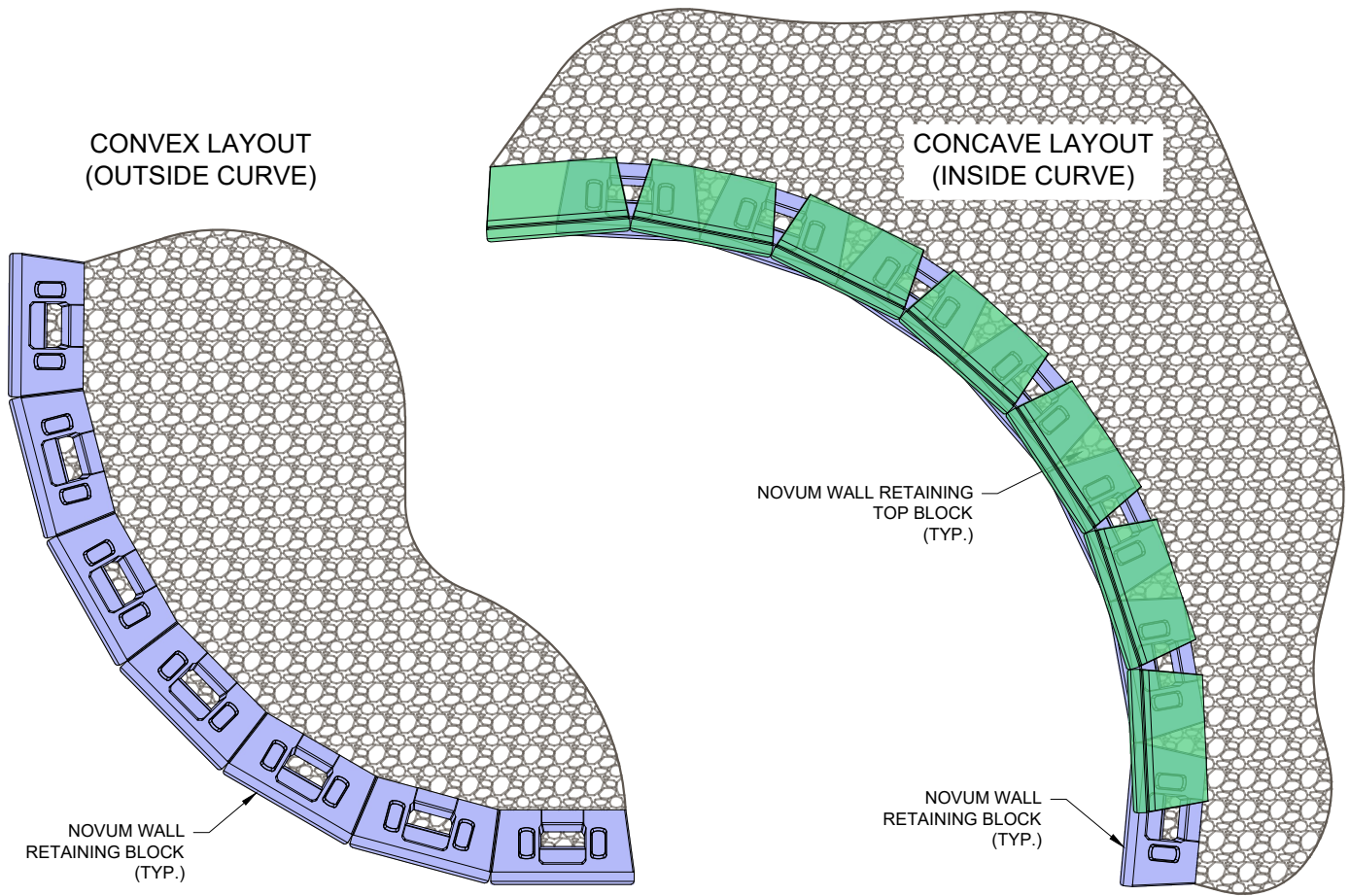

### MINIMUM RADIUS FOR BOTTOM ROW

NUMBER OF COURSES	HEIGHT OF WALL	RADIUS FROM FACE OF BASE BLOCK
1	0 ft - 9 in (0.23 m)	14 ft - 6 in (4.42 m)
2	1 ft - 6 in (0.46 m)	14 ft - 7 in (4.45 m)
3	2 ft - 3 in (0.69 m)	14 ft - 8 in (4.47 m)
4	3 ft - 0 in (0.91 m)	14 ft - 9 in (4.50 m)
5	3 ft - 9 in (1.14 m)	14 ft - 10 in (4.52 m)
6	4 ft - 6 in (1.37 m)	14 ft - 11 in (4.55 m)
7	5 ft - 3 in (1.60 m)	15 ft - 0 in (4.58 m)
8	6 ft - 0 in (1.83 m)	15 ft - 1 in (4.60 m)

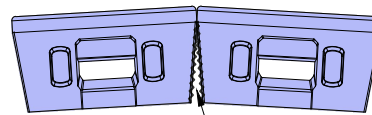

PLACE DRAINSTONE (REQUIRED) AND GEOTEXTILE FABRIC (RECOMMENDED) IN JOINT BETWEEN ADJACENT BLOCKS

14 ft - 6 in (4.42 m) is the minimum radius for Novum blocks. It occurs when all of the blocks are placed tight together. A larger radius is required on the bottom row of a Novum Wall to account for the batter between courses of blocks and still provide enough space to construct the top row of blocks.

This radius layout is based on a standard Novum Wall 5° face batter.

This drawing is for reference only. Determination of the suitability and/or manner of use of any details contained in this document is the sole responsibility of the design engineer of record. Final project designs, including all construction details, internal and external stability, and drainage, shall be prepared by a licensed professional engineer using the actual conditions of the proposed site.

DRAWN BY: TDG  
 APPROVED BY: LBH  
 DATE: 24-JAN-2024  
 SHEET: 1 of 1

TITLE: **CONCAVE AND CONVEX CURVES GRAVITY LAYOUT**  
 FILE: Concave\_and\_Convex\_Curves\_Gravity\_Layout.dwg

**NOVUM WALL™**  
 3890 CHARLEVOIX AVE, PETOSKEY, MI 49720  
 (866) 222-8400 ext 33010 • engineering@redi-rock.com • www.redi-rock.com